

INSTRUCTION MANUAL

Wi-Fi Dimmer Module

QS-WIFI-D04

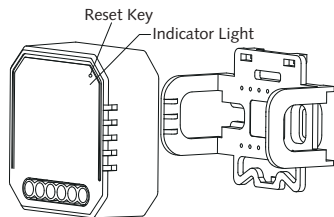

RoHS



TECHNICAL SPECIFICATIONS

Product type	WIFI dimmer module
Input Voltage	220-240V AC 50/60Hz
Output Voltage	0-10V DC Max.20mA
Protocol	2.4G-2.4835GHz WIFI
Operation temp	-5°C - +40°C
Operation range	≤ 10 m
Dims (WxDxH)	46x46x18 mm
IP rating	IP20
Warranty	2 years
Dimming type	0-10V

EMC Standard (EMC)

EN 300 328 V2.1.1 (2016-11),
EN 301489-1 V2.1.1 (2017-02),
EN 301489-17 V3.1.1 (2017-02),
EN 62311: 2008, EN 55015:2013
+A1:2015, EN 61547:2009

Safety Standard (LVD)

IEC 60669-2-1:2002/AMD1:2008/
AMD2:2015, IEC 60669-1:1998/
AMD1:1999/AMD2:2006,
EN 60669-2-1:2004+A1: 2009+ A2:2010,
EN 60669-1:2018

RoHS Standard (RoHS)

2011/65/EU, (EU) 2015/ 863

Radio Equipment (RED)

ETSI EN 300 328 V2.1.1 (2016-11)

Global international operation Whenever & Wherever
You are, All-in-one Mobile App

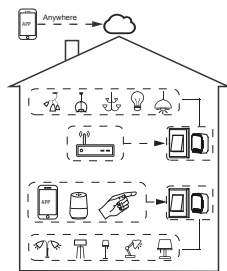

Inhouse local operation



INSTALLATION

▲ Warnings:

1. Installation must be carried out by a qualified electrician in accordance with local regulations.
2. Keep the device out of reach of children.
3. Keep the device away from water , damp or hot environment.
4. Install the device away from strong signal sources such as microwave oven that may cause signal interruption resulted to abnormal operation of the device.
5. Obstruction by concrete wall or metallic materials may reduce the effective operation range of the device and should be avoided.
6. Do NOT attempt to disassemble,repair or modify the device.

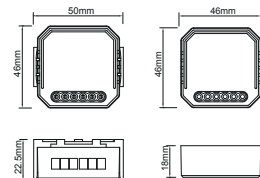

WIRING DIAGRAM

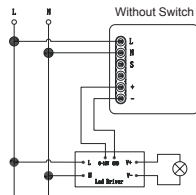
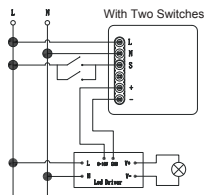
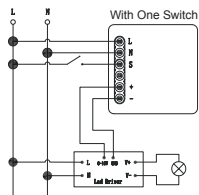

Wiring Instructions and Diagrams

1. Turn off the power supply before carrying out any electrical installation work.
2. Connect wires according to the wiring diagram.
3. Insert the module into the junction box.
4. Turn on the power supply and follow dimmer module configuration instructions.

Notes: Take your smartphone close to the dimmer module when you're configuring.

MANUAL OVERRIDE

The dimmer module reserves the access of manual override function for the end-user to switch on/off, or adjust the light level by push-switch.

- Short Push (<1s): permanent on/off function.
- Long Push (>1s): adjust the brightness level.

Notes:

- 1) Both the adjustment on App and push switch can overwrite each other, the last adjustment remains in memory.
- 2) App control is synchronized with the manual switch.
- 3) The "S" terminals may be left unconnected if no manual control is required.

Way of Reset:

1. Long press the reset key for about 10 seconds until the indicator light flash or the light connected to the device flash quickly.
2. Turn off the external manual switch, and then long press the external button switch for about 10 seconds until the indicator light flash or the light connected to the device flash quickly.
3. Power off the device first, then power on the device for about 10 seconds, and then power off/on for 5 times, during the 5 times, pls note that keep the power off time is more than 3 seconds, power on time is less than 2 seconds.

APP USER MANUAL



iOS APP / Android APP

1

Scan the QR code to download Tuya Smart App, or you can also search keyword "Tuya Smart" at App Store or Googleplay to download App.

2



Log in or register your account with your mobile number or e-mail address. Type in the verification code sent to your mobile or mail box, then set your login password. Click "Create Family" to enter into the APP.

3

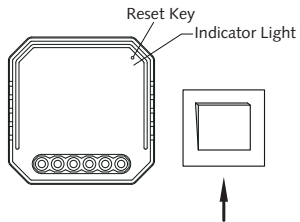

Turn off the light (the one connected to dimmer module), then press the switch and hold for 10 seconds or more until lamp connected to the module will flick quickly and enter into configuration mode. If you wait more than 120 seconds, you need to repeat this passage.

4



Open the APP, selecting "+" on top right to add device. Choose the type of device, for example "Smart Lighting".

5

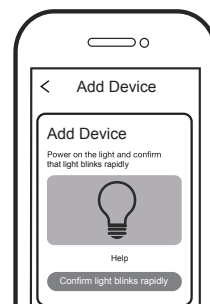

Make sure the bluetooth of your mobile phone is available. Confirm when the light flicks quickly (twice a second).

6

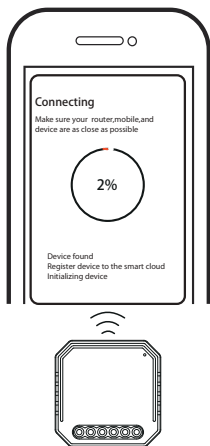

The pairing will take about 10-120 seconds to complete depending on your network condition.

7

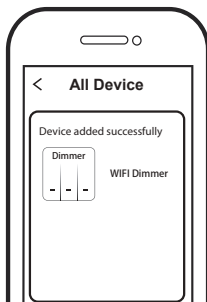

When pairing is done, the Wi-Fi dimmer will be shown on the App.

8

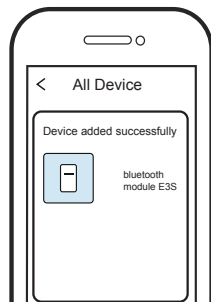

When pairing is done, the Bluetooth Mesh new device will be shown on the App.

9

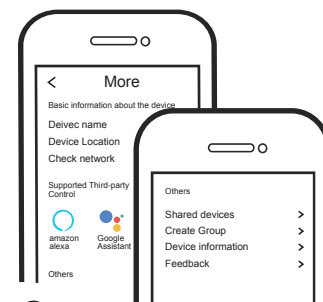

Connect to amazon alexa or Google Assistant for voice control, or share the devices with your families or friends.