

INSTRUCTION MANUAL

2 Gang Wi-Fi Dimmer Module

QS-WIFI-D02-TRIAC-2C

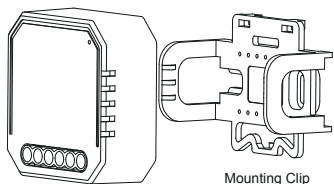

Mounting Clip



RoHS



TECHNICAL SPECIFICATIONS

Product type	2 Gang Wi-Fi Dimmer Module
Voltage	100-240V AC 50Hz
Max. load	2x100W
WiFi Frequency	2.4GHz - 2.4835GHz
Operation temp.	-10°C - +40°C
Case temp.	Tc: +80°C (Max.)
Operation range	< 200 m
Dims (WxDxH)	46*46*18mm(without clip)
IP rating	IP20
Warranty	2 years
Dimming type	Trailing Edge

EMC Standard (EMC)

EN 300 328 V2.1.1 (2016-11),
EN 301489-1 V2.1.1 (2017-02),
EN 301489-17 V3.1.1 (2017-02),
EN 62311:2008, EN 55015:2013
+A1:2015, EN 61547:2009

Safety Standard (LVD)

IEC 60669-2-1:2002/AMD1:2008/
AMD2:2015, IEC 60669-1:1998/
AMD1:1999/AMD2:2006,
EN 60669-2-1:2004+A1:2009+ A2:2010,
EN 60669-1:2018

RoHS Standard (RoHS)

2011/65/EU, (EU) 2015/863

Radio Equipment (RED)

ETSI EN 300 328 V2.1.1 (2016-11)

Global international operation Whenever & Wherever
You are, All-in-one Mobile App

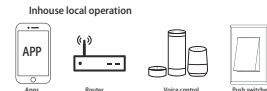
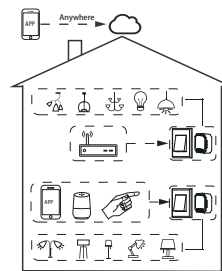
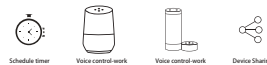

INSTALLATION

▲ Warnings:

1. Installation must be carried out by a qualified electrician in accordance with local regulations.
2. Keep the device out of reach of children.
3. Keep the device away from water, damp or hot environment.
4. Install the device away from strong signal sources such as microwave oven that may cause signal interruption resulted to abnormal operation of the device.
5. Obstruction by concrete wall or metallic materials may reduce the effective operation range of the device and should be avoided.
6. Do NOT attempt to disassemble, repair or modify the device.

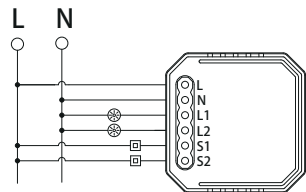
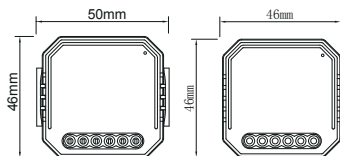
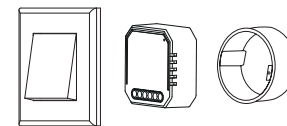

WIRING DIAGRAM

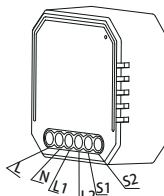

Wiring Instructions and Diagrams

1. Turn off the power supply before carrying out any electrical installation work.
2. Connect wires according to the wiring diagram.
3. Insert the module into the junction box. Or fix the module with mounting clip directly.
4. Turn on the power supply and follow dimmer module configuration instructions.

Notes: Take your smartphone close to the dimmer module when you're configuring, and make sure you have min. 50% Wi-Fi signal.

FAQ

- Q1: What should I do if I can't configure the dimmer module?
- a. Please check whether device is powered on.
 - b. Make sure your mobile and dimmer module are the same 2.4 GHz WIFI network.
 - c. Whether it's in good internet conditions.
 - d. Make sure the password entered in App is correct.
 - e. Make sure the wiring is correct.

Q2: What device can be connected to the Wi-Fi dimmer module?

Triac led light, incandescent light and halogen light.

Q3: What happens if the WIFI goes off?

You can still control the light connected the dimmer module with your traditional switch and once WIFI is active again the device connected to module will connect automatically to your WIFI network.

Q4: What should I do if I change the WIFI network or change the password?

You have to re-connect our Wi-Fi dimmer module to the new Wi-Fi network accordingly as per the App User Manual.

Q5: How do I reset the device?

Power off led light (the one connected to the wi-fi dimmer module). Then press and hold for 10 seconds or more until lamp connected to the module will flick quickly and enter into configuration mode.

MANUAL OVERRIDE

The dimmer module reserves the access of manual override function for the end-user to switch on/off, or adjust the light level by push-switch.

- Short Push (<1s): permanent on/off function.
- Long Push (>1s): adjust the brightness level.

Notes:

- 1) Both the adjustment on App and push switch can overwrite each other, the last adjustment remains in memory.
- 2) App control is synchronized with the manual switch.
- 3) The "S" terminals may be left unconnected if no manual control is required.

APP USER MANUAL



1 iOS APP / Android APP

Scan the QR code to download Tuya Smart App, or you can also search keyword "Tuya Smart" at App Store or Googleplay to download App.



2

Log in or register your account with your mobile number or e-mail address. Type in the verification code sent to your mobile or mail box, then set your login password. Click "Create Family" to enter into the APP.

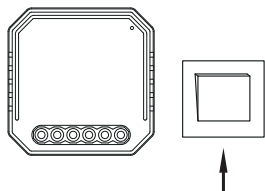

3

Turn off led light (the one connected to dimme module), then press the switch and hold for 10 seconds or more until lamp connected to the module will flick quickly and enter into configuration mode. If you wait more than 120 seconds, you need to repeat this passage.

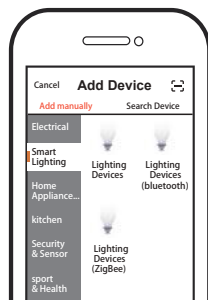

4

Open the APP, selecting "+" on top right to add device, and choose the correct device.

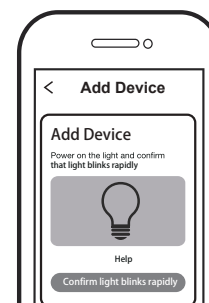

5

Make sure your smart phone and Wi-Fi Dimmer are under the same Wi-Fi network at 2.4GHz connection. Confirm when the light flicks quickly (twice a second).

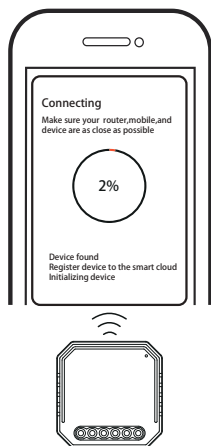

6

The pairing will take about 10-120 seconds to complete depending on your network condition.

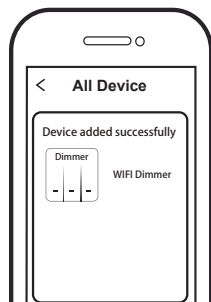

7

When pairing is done, the Wi-Fi dimmer will be shown on the App.

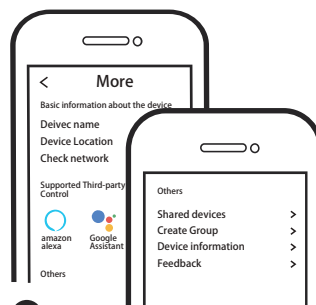

8

Connect to amazon alexa or Google Assistant for voice control, or share the devices with your families or friends.

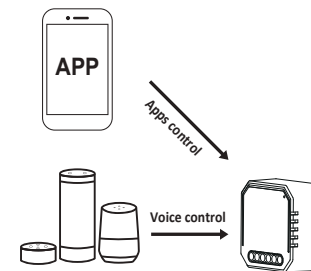

9

Enjoy your smart life of home automation for lighting control by using our All-in-one mobile app wherever you are in the world or simply by voice control when you are sitting at home comfortably.