

# INSTRUCTION MANUAL

## 2 Gang Bluetooth Switch Module

### QS-BLE-S04-2C

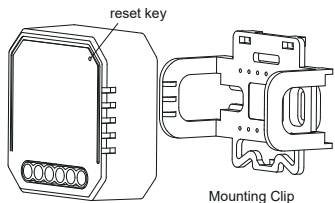

RoHS

www.aihomestyle.com

## TECHNICAL SPECIFICATIONS

Product type	2 Gang Bluetooth Switch Module
Voltage	220-240V AC 50Hz-60Hz
Max. load	2*1150W / 2*150W for LED lamp
Current	2x5A
Protocol	Bluetooth 4 wireless mesh
Operation temp.	-10°C - +40°C
Case temp.	Tc: +80°C (Max.)
Operation range	<10m
Dims (WxDxH)	46x46x18mm (Without clip)
IP rating	IP20
Warranty	3 years

EMC Standard (EMC)	EN 300 328 V2.1.1 (2016-11), EN 301489-1 V2.1.1 (2017-02), EN 301489-17 V3.1.1 (2017-02), EN 62311: 2008, EN 61000-6-1:2007, EN 61000-6-3:2007+A1:2011
Safety Standard (LVD)	IEC 60669-2-1:2002/AMD1:2008/ AMD2:2015, IEC 60669-1:1998/ AMD1:1999/AMD2:2006, EN 60669-2-1:2004+A1: 2009+ A2:2010, EN 60669-1:2018
RoHS Standard (RoHS)	2011/65/EU, (EU) 2015/863
Radio Equipment (RED)	ETSI EN 300 328 V2.1.1 (2016-11)

Global international operation Whenever & Wherever You are, All-in-one Mobile App

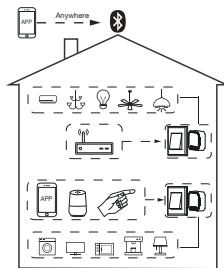

Inhouse local operation

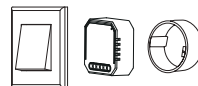

## INSTALLATION

▲ Warnings:

1. Installation must be carried out by a qualified electrician in accordance with local regulations.
2. Keep the device out of reach of children.
3. Keep the device away from water , damp or hot environment.
4. Install the device away from strong signal sources such as microwave oven that may cause signal interruption resulted to abnormal operation of the device.
5. Obstruction by concrete wall or metallic materials may reduce the effective operation range of the device and should be avoided.
6. Do NOT attempt to disassemble, repair or modify the device.

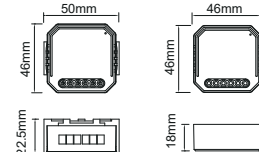

## Smart Phone to Device Range



Notes:

The range for which a smart phone can communicate with the switch points will vary from model to model and is dependant on its Bluetooth capability. Device placement will also effect the smart phone communication range and may appear different for each switch position. Finally, other environmental factors (as per opposite) will influence the ultimate achievable range of communication between smart phone and luminaire device.



Notes:

With BLE Mesh Gateway, the distance between Phone and Device can be more than 10m, where there's wifi, where the device can be controlled.

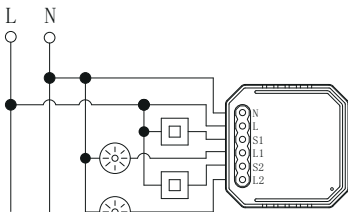

## Wiring Instructions and Diagrams

1. Turn off the power supply before carrying out any electrical installation work.
2. Connect wires according to the wiring diagram.
3. Insert the module into the junction box. Or install the module with its mounting clip.
4. Connect the power supply and follow switch module configuration instructions.

Notes: Take your smartphone close to the switch module when you're configuring.

## Please check in the following steps if you cannot find your bluetooth device:

1. Make sure your device is connected to the power source or the battery is charged.
2. Please enable the bluetooth of your mobile phone. For Android phones, it is required to location permission due to system configuration.
3. Keep the distance between the device and your mobile phone within 5m to ensure the connection of devices.
4. Make sure your device is ready to be added as follows:

\* For devices without button, you can power on the device repeatedly in 3 seconds intervals.

\* For devices with button or reset hole, you can try to press on/off the button for at least 5 times.

When the device is ready to be added, there will generally be a continuous beep from the module. If you still cannot add the device after, please give feedback to our staff in Personal Center > Feedback.

## MANUAL OVERRIDE

The switch module terminal reserves the access of manual override function for the end-user to switch on/off.

- Switch on/off for permanent on/off function.

Notes:

- 1) Both the adjustment on App and switch can overwrite each other, the last adjustment remains in memory.
- 2) The App control is synchronized with the manual switch.

## APP USER MANUAL



## 1 IOS APP / Android APP

Scan the QR code to download Tuya Smart App, or you can also search keyword "Tuya Smart" at App Store or Googleplay to download App.

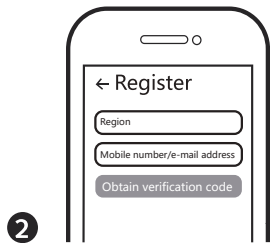

2

Log in or register your account with your mobile number or e-mail address. Type in the verification code sent to your mobile or mail box, then set your login password. Click "Create Family" to enter into the APP.

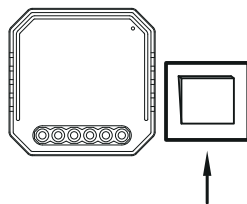

3

After the wiring of switch module is done, press the traditional switch to turn ON/OFF cycle for 5 times (keep time interval not too short) until the beep sound continuously for pairing mode. Or press the reset key for about 10s for pairing mode.

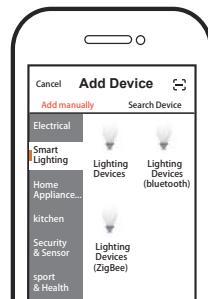

4

Open the APP, selecting "+" on top right to add device. Choose the type of Bluetooth device.

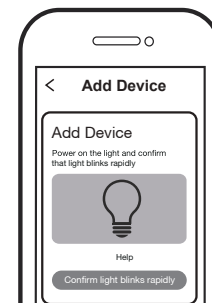

5

Confirm when there's a continuous beep from the module.

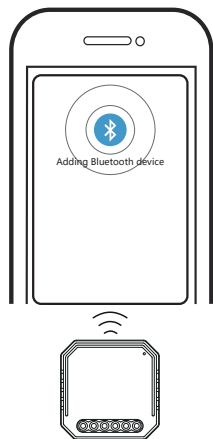

6

The connecting will take about 10-120 seconds to complete depending on your network condition.

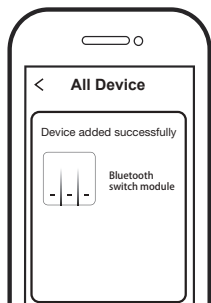

7

When pairing is done, the Bluetooth switch module will be shown on the App.

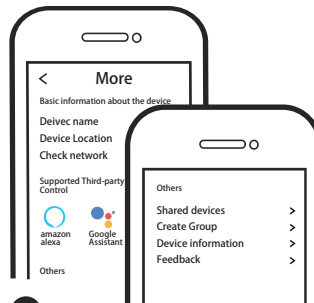

8

Connect to amazon alexa or Google Assistant for voice control, or share the devices with your families or friends.

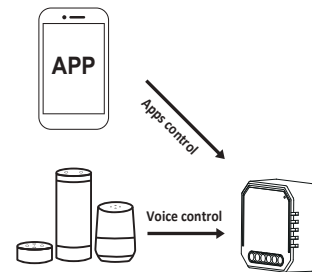

9

Enjoy your smart life of home automation for lighting control by using our All-in-one mobile app wherever you are in the world or simply by voice control when you are sitting at home comfortably.